



LIGHTSHOW™ POWERWING®



OWNER'S MANUAL

Read and understand this entire manual before allowing child to use this product! For assistance contact Razor. DO NOT RETURN TO STORE.

NOTE: Manual illustrations are for demonstration purposes only. Illustrations may not reflect exact appearance of actual product. Specifications subject to change without notice.

Please have your product along with the 22 character product I.D. code with you before contacting Razor for warranty assistance and/or replacement parts.

Product I.D. Code: _____ - _____ - _____

CONTENTS

Safety Warnings.....	1	Repair and Maintenance.....	6
Before You Begin.....	2	PowerWing Lightshow Parts.....	7
Assembly and Set-Up.....	3-4	Warranty and Contact Information.....	10
Pre-Ride Checklist and Usage.....	5		

SAFETY WARNINGS

⚠ AN IMPORTANT MESSAGE TO PARENTS: This manual contains many warnings and cautions concerning the consequences of failing to maintain, inspect or properly use your PowerWing Lightshow. Because any incident can result in serious injury or even death, we do not repeat the warning of potential serious injury or death each time such a possibility is mentioned.

⚠ WARNING: Riding the PowerWing Lightshow can be a hazardous activity. Certain conditions may cause the equipment to fail without fault of the manufacturer. Like other wheeled products, the PowerWing Lightshow can and is intended to move, and it is therefore possible to lose control, fall off and/or get into dangerous situations that no amount of care, instruction or expertise can eliminate. If such things occur, your child can be seriously injured or die, even when using safety equipment and other precautions. USE COMMON SENSE.

APPROPRIATE RIDER USE AND PARENTAL SUPERVISION

Direct adult supervision is required at all times. This manual contains important safety information. It is your responsibility to review this information and make sure that all children obey all warnings, cautions, instructions and safety topics, and assure that young riders are able to safely use this product. Razor recommends that you periodically review and reinforce the information in this manual with young riders, and that you inspect and maintain your children's product to ensure their safety.

The recommended rider age of 6 years and older for the PowerWing Lightshow is only an estimate, and can be affected by the rider's size, weight or ability. Any child unable to fit comfortably on the PowerWing Lightshow should not attempt to ride it.

A parent's decision to allow his or her child to ride this product should be based on the child's maturity, skill and ability to follow rules.

Do not exceed 143 lb (65 kg) on the PowerWing Lightshow.

Rider weight does not necessarily mean a child's size is appropriate to fit or maintain control of the PowerWing Lightshow.

ACCEPTABLE RIDING PRACTICES AND CONDITIONS

Direct parental supervision is required. The PowerWing Lightshow is meant to be used only in controlled environments, free of potential traffic hazards and not on public streets. Do not allow your child to ride the PowerWing Lightshow in any areas where vehicle traffic is present. Child must maintain a hold on the handlebars at all times. Never allow more than one child at a time to ride the PowerWing Lightshow. Never use near steps, sloped driveways, hills, roadways, alleys or swimming pool areas.

Do not ride the PowerWing Lightshow in wet weather. The PowerWing Lightshow is intended for use on solid, flat, clean and dry surfaces, such as pavement or level ground, without loose debris such as rocks or gravel. Wet, slick or uneven and rough surfaces may impair traction and contribute to possible accidents. Do not ride the PowerWing Lightshow in mud, ice, puddles or water. Avoid excessive speeds that can be associated with downhill rides. Never risk damaging surfaces, such as carpet or flooring, by use of a PowerWing Lightshow indoors. Do not ride at night or when visibility is impaired.

PROPER RIDING ATTIRE

Always ensure child is wearing proper protective equipment, such as an approved safety helmet. A helmet may be legally required by local law or regulation in your area. A child should always wear shoes and keep shoelaces tied and out of the way of the wheels. Never ride barefooted or in sandals.

⚠ WARNING: ALWAYS INSPECT POWERWING LIGHTSHOW PRIOR TO RIDING. Properly inspecting and maintaining your PowerWing Lightshow can reduce the risk of injury. Always inspect your PowerWing Lightshow before riding and regularly maintain it.

⚠ WARNING: CHECK LOCAL LAWS REGARDING POWERWING LIGHTSHOW USE. Check local laws and regulations to see where and how you may use your Razor PowerWing Lightshow legally. In many states and local areas, PowerWing Lightshow riders may be required BY LAW to wear a helmet. Check local laws and regulations regarding laws governing helmet use and PowerWing Lightshow operation in your area.

⚠ WARNING: AA BATTERIES

This product contains AA batteries. A swallowed AA battery can cause internal chemical burns. Dispose of used batteries immediately. Keep new and used batteries away from children. If you think batteries might have been swallowed or placed inside any part of the body, seek immediate medical attention.

Batteries included for lights - adult attention for changing and disposal.

Batteries should only be replaced by an adult.

Loose batteries could present a choking hazard and should be kept away from small children.

Dispose of batteries properly.

FAILURE TO USE COMMON SENSE AND HEED THE ABOVE WARNINGS FURTHER INCREASES RISK OF SERIOUS INJURY. USE AT YOUR OWN RISK AND WITH APPROPRIATE AND SERIOUS ATTENTION TO SAFE OPERATION. USE CAUTION.

Need Help? Visit our website for replacement parts, product support, a list of authorized service centers in the US and customer service contact information at www.razor.com. Please have the product I.D. code (located on the white label of your product) available for better assistance. Additional Customer Service contact information is listed at the back of this manual.

BEFORE YOU BEGIN

Remove contents from box and check parts against part diagram below. Remove the separators that protect the components from damage during shipping. Inspect the contents of the box for scratches in the paint, dents or kinked cables that may have occurred during shipping. Because the PowerWing Lightshow is partially assembled and packed at the factory, there should not be any problems even if the box has a few scars or dents.

Estimated Assembly and Set-Up Time

Allow up to 15–20 minutes for assembly. Razor recommends assembly by an adult.

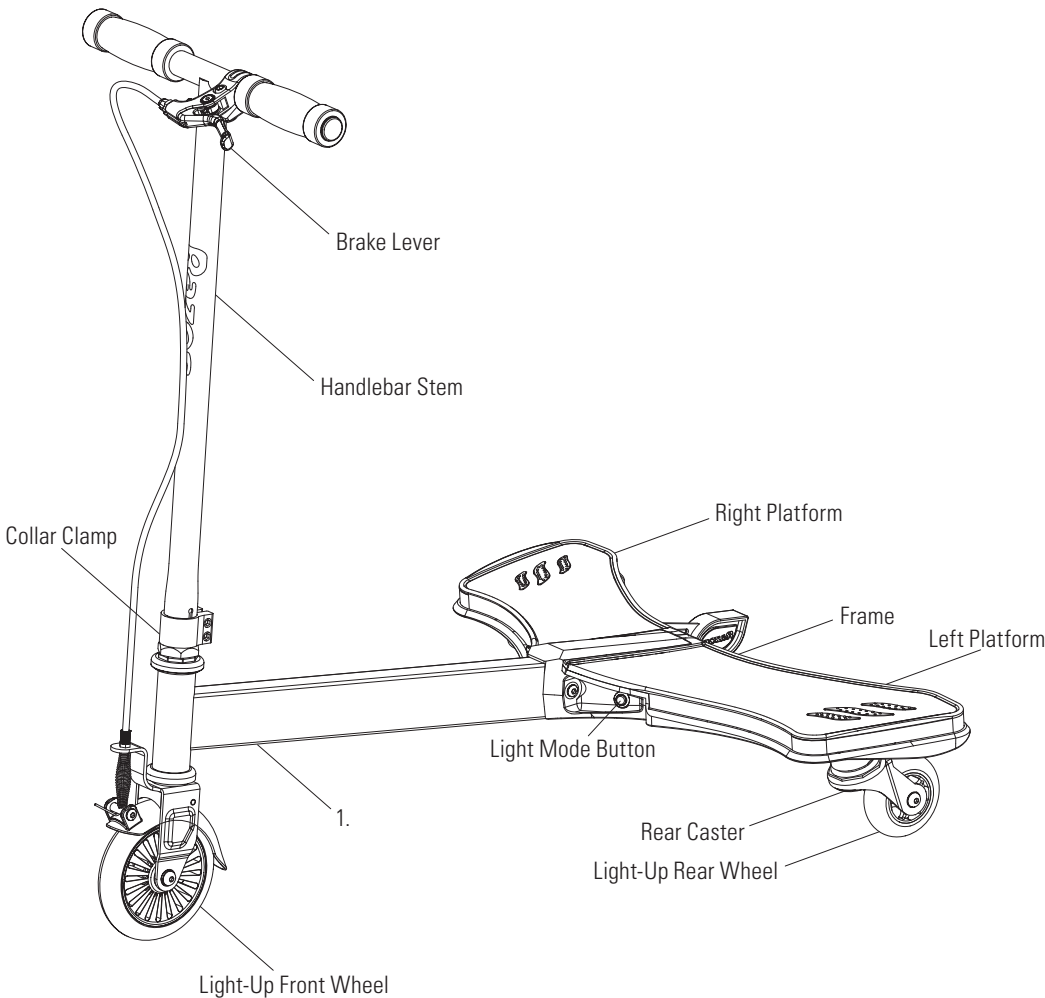

Required Tools

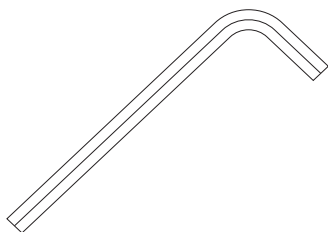

Two (2) 5 mm Allen Wrenches
(Included)

WARNING: DO NOT USE NON-RAZOR PRODUCTS WITH YOUR POWERWING LIGHTSHOW. The PowerWing Lightshow has been built to certain Razor design specifications. The original equipment supplied at the time of sale was selected on the basis of its compatibility with the frame, fork and all other parts. Certain aftermarket products may not be compatible and will void the warranty.

Product ID Locations:

(See locations to the left)

1. Side of frame
2. Barcode on side of box (not shown)

Box Contents:

- PowerWing Lightshow
- Allen Wrenches
- Owner's Manual

Need Help? Visit our website for replacement parts, product support, a list of authorized service centers in the US and customer service contact information at www.razor.com. Please have the product I.D. code (located on the white label of your product) available for better assistance. Additional Customer Service contact information is listed at the back of this manual.

ASSEMBLY AND SET-UP

□ Attaching the Deck Assembly

Required Tool: 5 mm Allen Wrench (included)

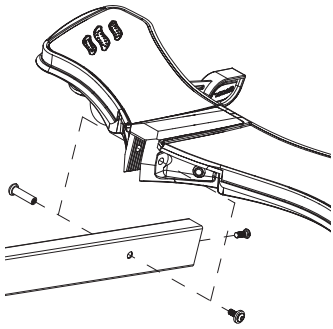

1 Place the deck assembly onto the frame. Then using a 5 mm Allen wrench, tighten the left, right and rear screw in that order.

□ Attaching the Handlebars

Required Tool: 5 mm Allen Wrench (included)

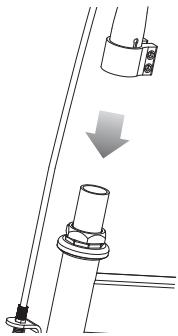

1 Place the handlebar stem onto the front fork.

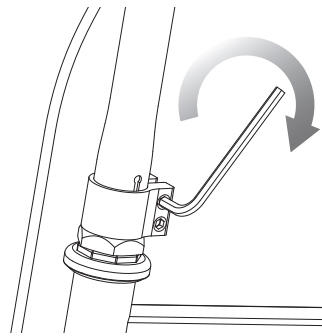

2 With the front wheel pointed straight ahead, the handlebars square to the front wheel and the Razor logo facing the front, use a 5 mm Allen wrench to tighten the two (2) bolts on the collar clamp. The collar clamp is properly tightened when the handlebars cannot be twisted out of alignment with the front wheel.

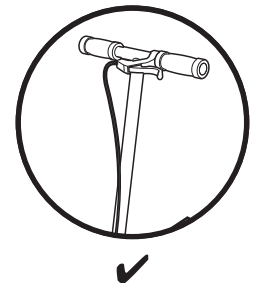
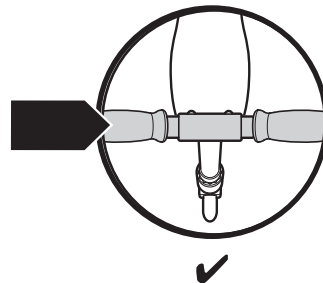
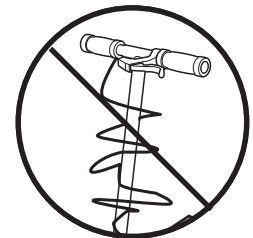
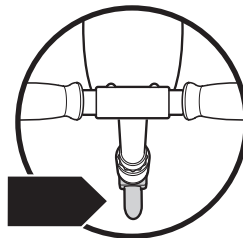

Note: The cable assembly from the handlebar must not wrap around the handlebar stem. Sharp bends or twisting of the brake cable can cause the brake to malfunction.

ASSEMBLY AND SET-UP

□ Adjusting the Brake

Required Tools: 3 mm Allen Wrench and 8 mm Wrench (not included)

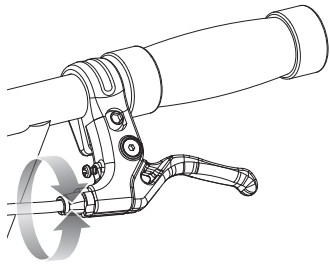

1 To adjust the brake cable wire, thread the brake lever adjuster in or out 1/4 to 1/2 turn until the desired cable tension is attained.

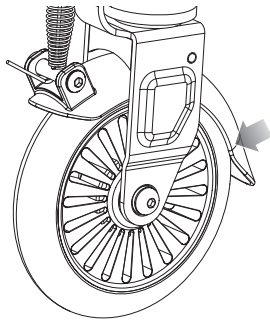

2 Squeeze the brake lever to test the brake to make sure it is working properly. The front fender should clamp down and rub against the front wheel. If brake is not working properly, proceed to the next step.

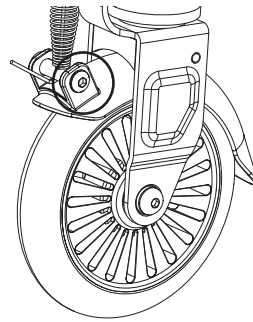

3 If the brake is too tight or too loose, use a 8 mm wrench and a 3 mm Allen wrench to adjust as needed.

□ Activating the Batteries

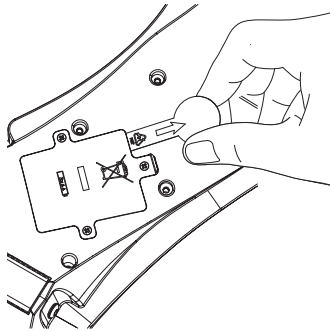

1 To activate the batteries, locate the battery compartment on the bottom of the deck and remove the plastic battery tab from under the battery cover. Please note that the battery tab may have been previously removed. If the battery tab is missing there is no cause for concern, as this will not affect the functionality of your PowerWing Lightshow.

PRE-RIDE CHECKLIST



Loose Parts

Check and secure all fasteners before every ride. Make sure the steering bolts and foot platforms are tight. There should not be any unusual rattles or sounds from loose parts or broken components. If you are not sure, call 1-866-467-2967 for assistance.



Replacement Parts

Replace worn or broken parts immediately. Call 1-866-467-2967 for parts or visit www.razor.com.



Brake

Check the brake for proper function. When you squeeze the brake lever, the brake should provide positive braking action.



Frame, Fork and Handlebars

Check for cracks or broken connections. Although broken frames are rare, it is possible for an aggressive rider to run into a curb or wall and wreck, bend or break a frame. Get in the habit of inspecting yours regularly.



Safety Gear

Always wear proper protective equipment, such as an approved safety helmet, elbow pads and kneepads. Always wear shoes (lace-up with rubber soles) and keep shoelaces tied and out of the way of the wheels. Never ride barefooted or in sandals.

USAGE

How to Ride

Place both hands on the handlebars. Place one foot on the platform directly above the caster. Push off with the other foot then place foot on the other platform directly above the caster. Slightly bend knees. With handlebars straight, swing hips and legs side to side. Shifting weight on the platforms from right to left in sync with hips and legs. The side to side motion acts to self propel the PowerWing Lightshow. No pushing required.

How to Operate Lights

1. There is no power switch to active the lights on the deck or wheels.
2. The deck lights are activated by a vibration sensor.
3. Deck and wheel lights are activated when PowerWing Lightshow is in motion.
4. Deck lights will remain on for approximately 20 seconds after PowerWing Lightshow has stopped moving. Lights are re-activated when PowerWing Lightshow resumes motion.
5. The PowerWing Lightshow has five (5) light modes. Press the button **(A)** at the front left side of the deck and the light will be switched to the next mode.

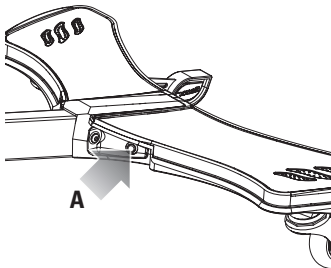

How to Stop

Apply hand brake by squeezing brake lever.



Note: Do not step off of platforms until unit has come to a complete stop.

Need Help? Visit our website for replacement parts, product support, a list of authorized service centers in the US and customer service contact information at www.razor.com. Please have the product I.D. code (located on the white label of your product) available for better assistance. Additional Customer Service contact information is listed at the back of this manual.

REPAIR AND MAINTENANCE

□ Replacing the Batteries

Required Tool: Phillips Screwdriver (not included)

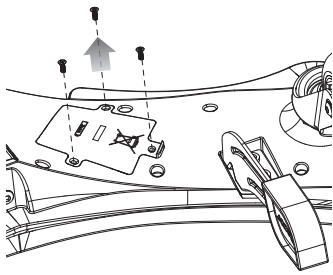

1 Using a Phillips screwdriver, remove the three (3) screws from the top of battery cover.

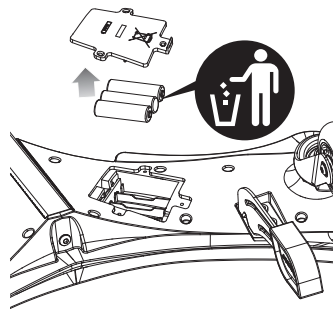

2 Remove the battery cover and set aside. Remove and discard the old batteries.

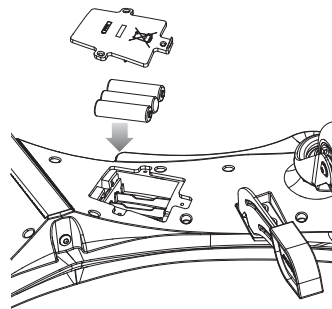

3 Insert the new AA batteries and replace the cover and tighten the screw using a Phillips screwdriver.

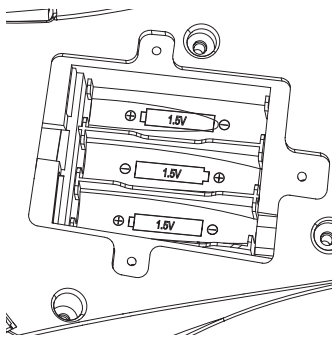

Note: When installing the batteries, please pay attention to the batteries' positive and negative side which must align with the positive and negative markings in the battery housing.

□ Cleaning Your PowerWing Lightshow

Wipe with a damp cloth to remove dirt and dust. Do not use industrial cleaners or solvents as they may damage the surfaces. Do not use alcohol, alcohol-based or ammonia-based cleaners as they may damage or dissolve the plastic components or soften the decals or decal adhesive.

□ Wheels and Bearings

Under normal circumstances and conditions, Razor wheels and wheel bearings are maintenance free. Nonetheless, it is the responsibility of the owner or guardian to periodically inspect the wheels for wear and tear, the axle for proper tightness, and bearings for side-to-side play, and loose parts. When a wheel or wheel bearing develops play, this is an indication of excess wear and replacement is necessary. Replace immediately with only genuine Razor wheels. Worn wheels/bearings are considered normal wear-and-tear and are not covered by the Razor Warranty. Wheels other than genuine Razor wheels may not be compatible with your Razor product. The use of anything other than genuine Razor replacement parts may affect your safety and will void your warranty.

□ Replacement Parts

The most frequently requested replacement parts are available for purchase at some Razor retail partners. For the complete selection of replacement parts visit www.razor.com.

□ Repair Centers

For a list of authorized Razor repair centers:

- Check online at www.razor.com.
- Additional Customer Service contact information is listed at the back of this manual.

⚠ **WARNING:**

AA batteries included for lights - adult attention for changing and disposal.

- Batteries should only be replaced by an adult.
- Loose batteries could present a choking hazard and should be kept away from small children.
- Do not mix old and new batteries.
- Do not mix alkaline, standard (carbon-zinc) or rechargeable (ni-cad, ni-mh, etc.) batteries.
- Dispose of batteries properly.

Note: Batteries are not covered under the Limited Warranty.

Need Help? Visit our website for replacement parts, product support, a list of authorized service centers in the US and customer service contact information at www.razor.com. Please have the product I.D. code (located on the white label of your product) available for better assistance. Additional Customer Service contact information is listed at the back of this manual.

POWERWING LIGHTSHOW PARTS

Keep your PowerWing Lightshow working for years with genuine Razor parts. Visit our website www.razor.com to purchase replacement parts. (Specifications subject to change without notice.)

- | | | |
|------------------------|--|--------------------------------|
| 1. T-Bar | 7. Steel Frame | 12. Stability Bar (Left/Right) |
| 2. Brake Cable | 8. Light Mode Button | 13. Deck Assembly |
| 3. Headset | 9. Battery Cover | 14. LED Strip Assembly |
| 4. Front Fork Assembly | 10. Batteries (3x AA batteries) | 15. LED Cover (Left/Right) |
| 5. Brake Spring | 11. Caster and Light-Up Rear Wheel Assembly (Left/Right) | |

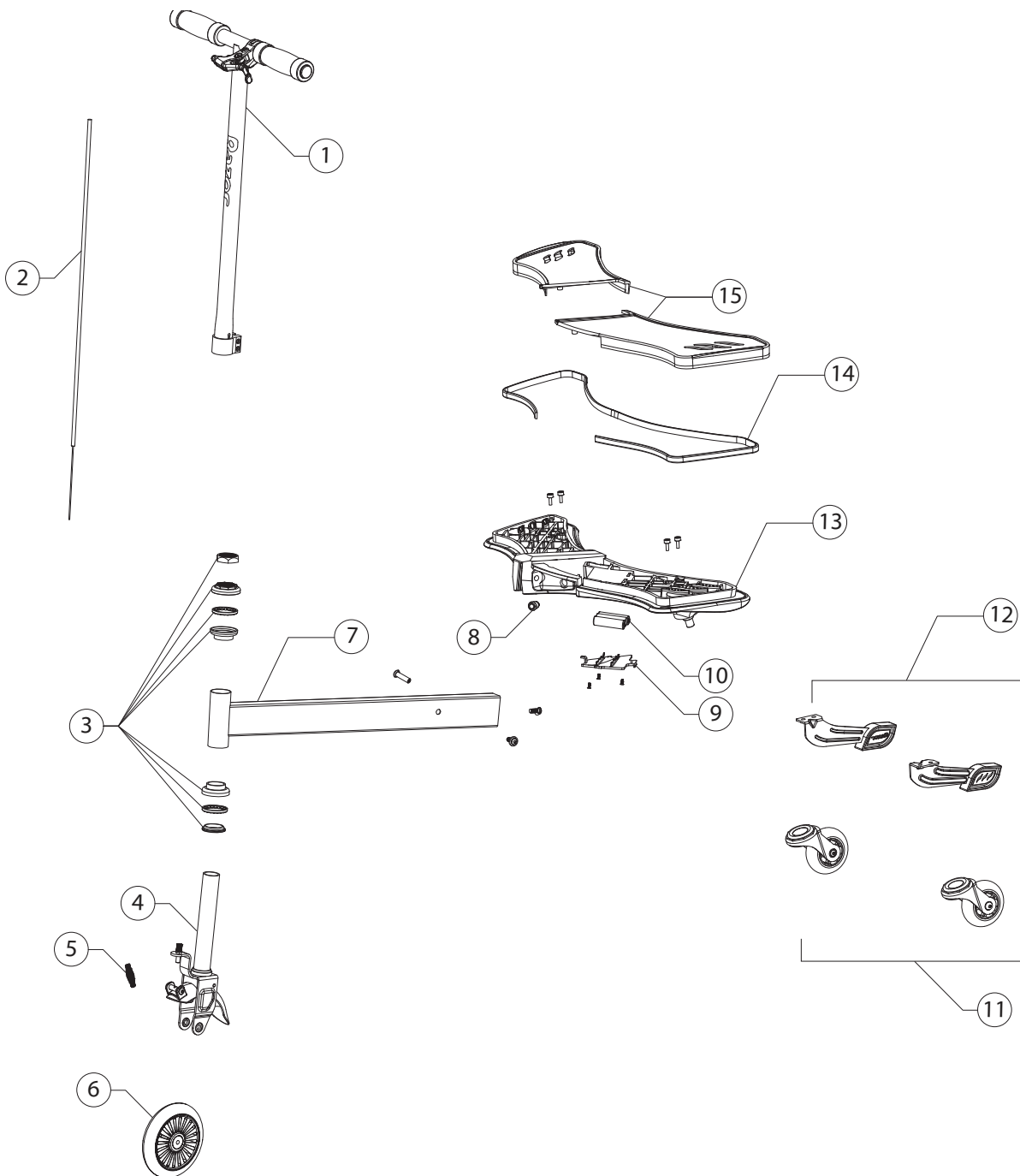

WARRANTY

Razor Limited Warranty

The manufacturer warrants this product to be free of manufacturing defects for a period of 6 months from date of purchase. This Limited Warranty does not cover normal wear and tear, wheels, or any damage, failure or loss caused by improper assembly, maintenance, storage or use of the Razor PowerWing Lightshow.

This Limited Warranty will be void if the product is ever:

- used in a manner other than for recreation or transportation;
- modified in any way;
- rented.

The manufacturer is not liable for incidental or consequential loss or damage due directly or indirectly to the use of this product.

Razor does not offer an extended warranty. If you have purchased an extended warranty, it must be honored by the store at which it was purchased.

For your records, save your original sales receipt with this manual and write the serial number below.

CUSTOMER SERVICE CONTACT INFORMATION

Need Help? Visit our website for product support, a list of authorized service centers in the US and customer service contact information at www.razor.com. Please have the product I.D. code (located on the white label of your product) available for better assistance. Additional Customer Service contact information is listed below:

AMERICAS

Razor USA LLC
P.O. Box 3610
Cerritos, CA 90703
USA

+1 866 467 2967
Monday - Friday
8:00 AM - 5:00 PM Pacific Time
customersupport@razorusa.com

EUROPE, MIDDLE EAST, AFRICA

Razor USA LLC (Europe)
Handelsweg 2
2742 RD Waddinxveen
Netherlands

+44 (0) 120 267 2702
info@razoreu.com

ASIA

Razor USA LLC (Asia)
P.O. Box 3610
Cerritos, CA 90703
USA

+81 50 7579 6622
info@razor-asia.com

UNITED KINGDOM AND IRELAND

Razor USA LLC (UK)
Unit 20
Hartnoll Business Centre
Post Hill, Tiverton
Devon EX16 4NG
UK

+44 (0) 120 267 2702
info@razoreu.com

AUSTRALIA AND NEW ZEALAND

Razor USA LLC (AU and NZ)
P.O. Box 4280
Auburn South VIC 3122,
Australia

+1 800 954 354 (AU)
+0 800 003 221 (NZ)
info@razoranz.com

US Patent No. 7,597,334 B2, 7,681,895 B2 & 7,784,803 B2

Printed in China for Razor USA LLC.

Copyright © 2003-2021 Razor USA, LLC. All rights reserved. Razor®, the Razor logo design, PowerWing®, and the PowerWing logo design among the registered trademarks of Razor USA LLC in the United States and/or select foreign countries. Lightshow™ and the Lightshow logo design is a trademark of Razor USA LLC.